

MAXUS

MAXUS MIFA
MPV,5 Doors
2022-

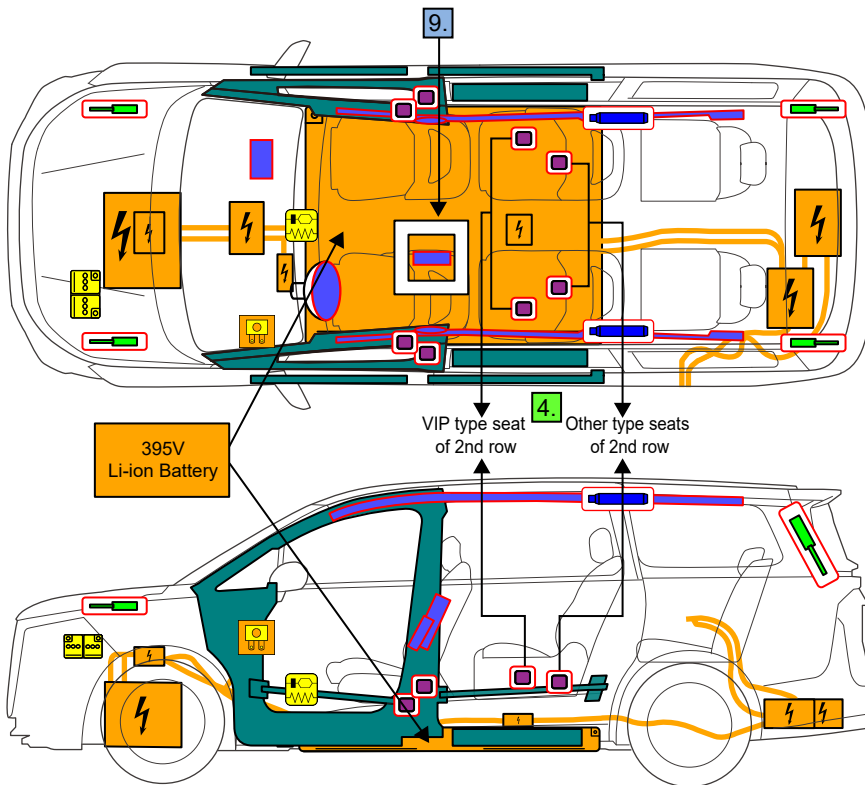

	Airbag		Stored gas inflator		Seat belt pretensioner		SRS control unit		Gas strut/Preloaded spring
	High strength zone		Zone requiring special attention		Battery low voltage		High voltage battery pack		High voltage power cable/component
	Fuse box disabling high voltage system		High voltage component						
			ID No.	Version No.		Version date		Page	
			LSK-MIFA-EV-E001	01		06/2022		1 of 4	

1. Identification / recognition



2. Immobilisation / stabilisation / lifting

A - Immobilisation / stabilisation

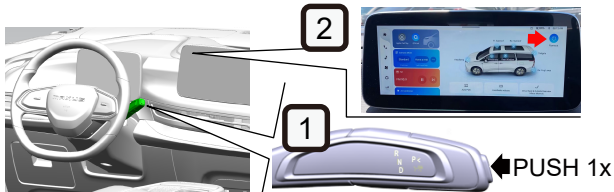

- 1 Secure the vehicle using P gear and parking brake
Just press the button once, P gear and parking brake work at the same time.
- 2 Click the "power off" button on the screen.

B - Lifting

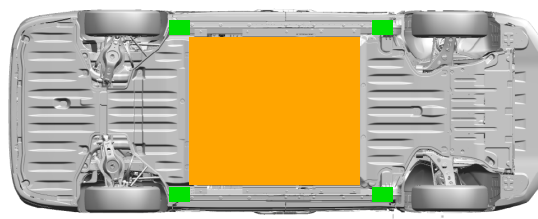

■ Suitable lifting points ■ High-voltage battery

3. Disable direct hazards / safety regulations

Turn off - main method for disable direct hazards

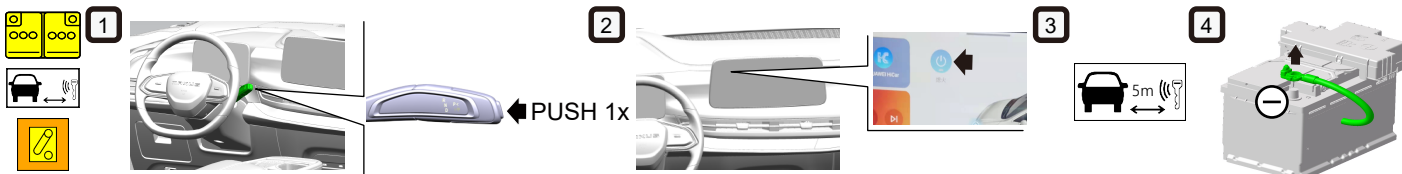

- Just press the button once, The vehicle will be in P.
- Click the "power off" button on the screen.

- Disconnect 12 Volt battery

Emergency shutdown - alternative method for disable direct hazards

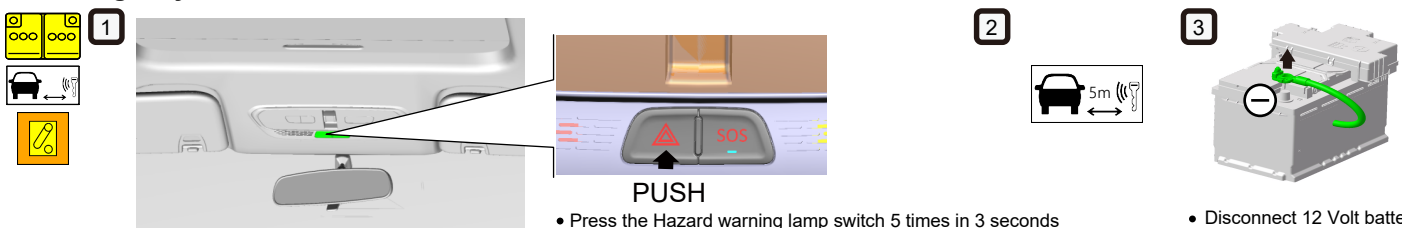

- Press the Hazard warning lamp switch 5 times in 3 seconds

- Disconnect 12 Volt battery

Deactivating the high-voltage system – alternative method for deactivation in the vehicle interior

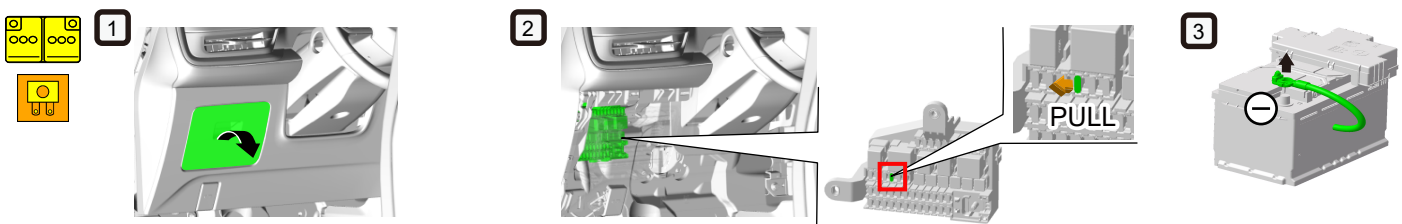

- Open and remove the driver-side compartment

- Pull out the F27 fuse as shown

- Disconnect 12 Volt battery

	ID No.	Version No.	Version date	Page
	LSK-MIFA-EV-E001	01	06/2022	2 of 4

3. Disable direct hazards / safety regulations

■ Disconnect from the charging station (emergency release)

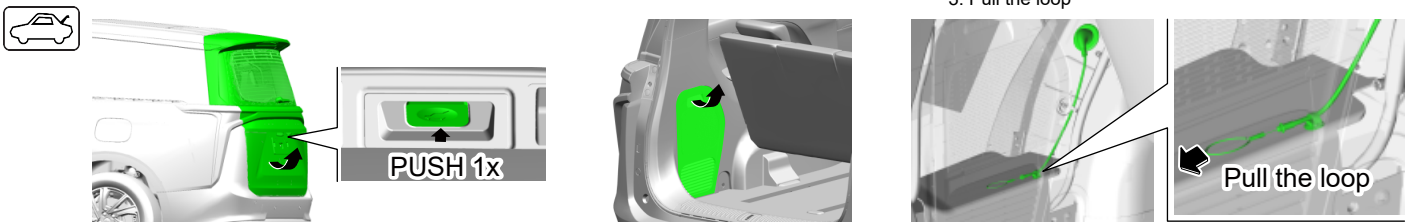

■ Access to 12V Battery

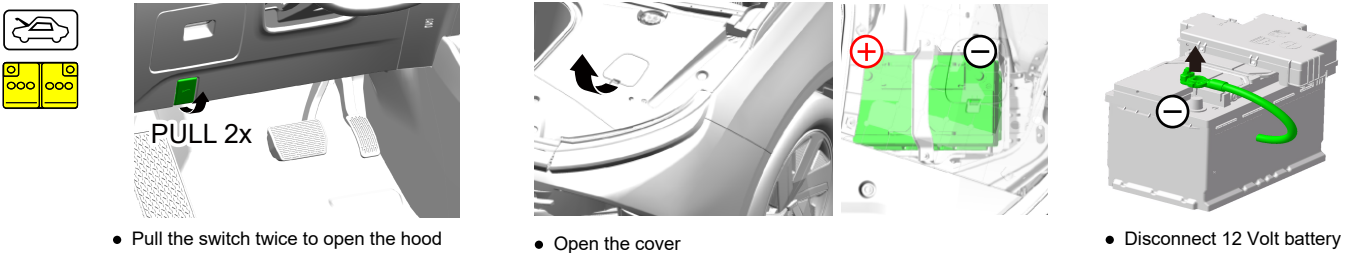

Safety regulations:

! Always assume the vehicle is powered, even if it is silent!
 Make sure that the vehicle is immobilized and the propulsion system is deactivated;
 Never touch, cut, or open any orange high voltage power cable or high voltage component;
 In case of a collision with airbag deployment and/or seat belt pretensioner activation, the propulsion system will be disabled. The restraint systems are still active.

4. Access to the occupants

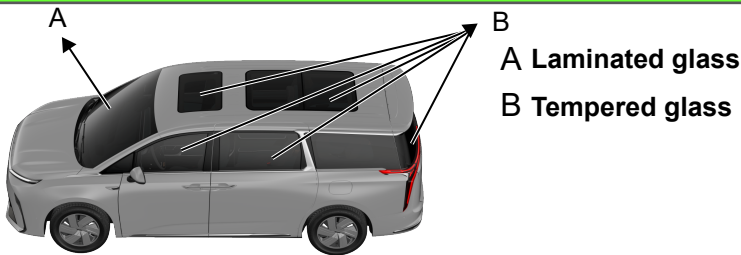

High strength body areas



Seat adjustment

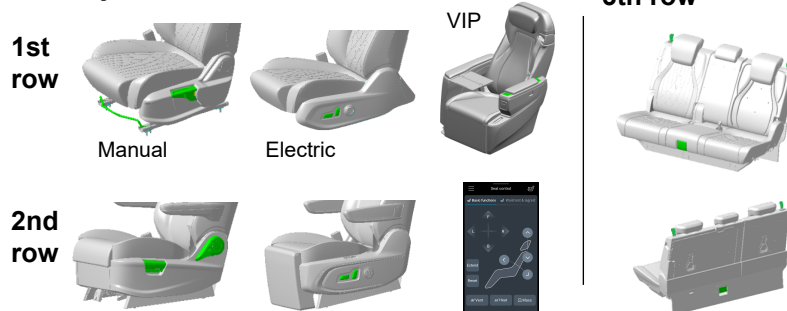

Steering column adjustment

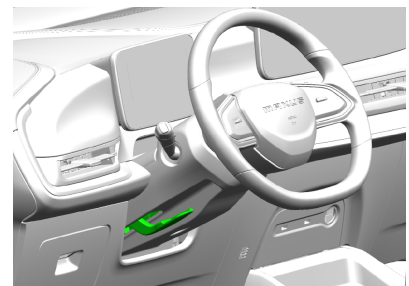

5. Stored energy / liquids / gases / solids

	395V
	12V
	R-1234yf 1000g

! If coolant escapes from the battery cooling system, there is a risk of a thermal reaction, in the high-voltage battery. Monitor the temperature of the high-voltage battery!



	ID No.	Version No.	Version date	Page
	LSK-MIFA-EV-E001	01	06/2022	3 of 4

6. In case of fire



USE LARGE AMOUNT OF WATER

If it is difficult to apply copious amounts of water to the high voltage battery, it is recommended to allow the high voltage battery to burn itself out.



BATTERY RE-IGNITION!

7. In case of submersion

Wear appropriate PPE. Remove the vehicle from the water and continue with the deactivation procedure for this vehicle (see chapter 3). Vehicles submerged in salt water should be handled with a greater potential risk of a HV battery fire.

8. Towing / transportation / storage

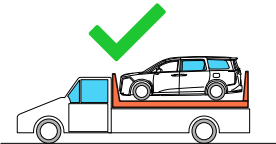
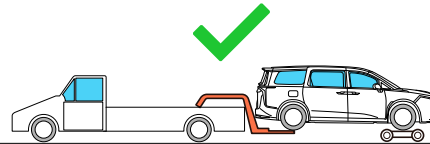
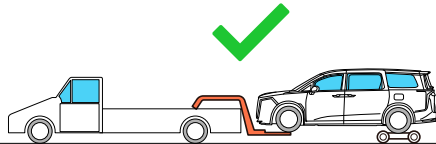
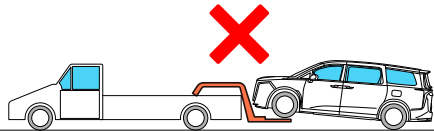
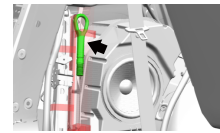
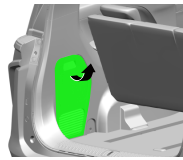
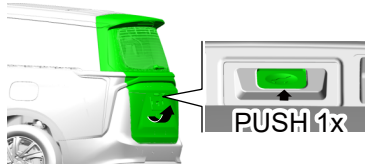

9. Important additional information

■ Centre airbag

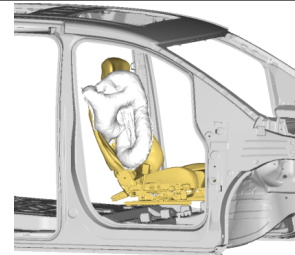
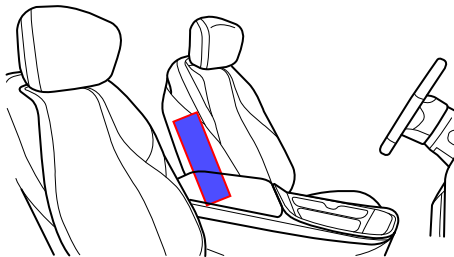

10. Explanation of pictograms used

Flammable	Hazardous to the human health	Acute toxicity	Corrosives	Environmental hazard	Explosive	Warning, Electricity	General warning sign
Use water to extinguish the fire	Use thermal Infrared camera	Remove smart key	Bonnet	Boot	Low voltage device that disconnects high voltage	Electric Vehicle	Air-conditioning component
	ID No.	Version No.	Version date	Page			
	LSK-MIFA-EV-E001	01	06/2022	4 of 4			